

Dual Band Wireless Embedded Board

Model: YBT342

Revision:1.03 IL
Date: 2014,11,11

Features

- CompexWRT and OpenWRT firmware supported
- Qualcomm-Atheros 560MHz Networking Processor AR9342
- 5GHz up to 26dBm aggregate power 2 x 2 on-board radio
- Integrated Power-over-Ethernet
- Support 2 x FE Port
- Support Third Party 3G/LTE Module

Applications

- Dual Band, Dual Concurrent AP
- 802.11a/n+802.11b/g/n AP
- Point to Point / Point to MultiPoint
- Base Station
- CPE
- Support Third Party 3G/LTE Module

Technical Specifications

System Information						
Processor		Qualcomm-Atheros AR9342				
System Memory		64MB DDR2				
NOR Flash		16MB				
PCIe Slot		9.2mm height miniPCIe slot				
On-board radio power		26dBm(aggregate)				
On-board radio Antenna Connector		2 x U.F L				
Ethernet		2 x FE Port with Auto-MDI/X				
Extras		Serial Port ¹ , JTAG ² , Reset Button, Surge Arrestor, Watchdog Timer				
Power Solutions	Low voltage	DC Jack Input: 12-24V, Passive PoE: 24V				
	High voltage	IEEE 802.3af module(Optional) ³ ,DC Jack input:24-56V, Passive PoE:24-56v, compatible with802 .3af/802.3at PoE switches and injectors				
Power Consumption		5.5W				
ROHS Compliance		Yes				
Humidity		Operating: 5% to 95% (non-condensing) Storage: Max.90% (non-condensing)				
Temperature Range		Operating: -20°C to 70°C Storage: -40°C to 90°C				
Dimension		95 X 105 x 18 (mm)				
5G On-board Radio	Transmit Power	Frequency	Data Rate	5GHz (aggregate)		
		5180MHz	6Mbps	24dBm		
			54Mbps	20dBm		
			HT20 MCS0	23dBm		
			HT20 MCS7	18dBm		
			HT40 MCS0	23dBm		
			HT40 MCS7	18dBm		
		5500MHz	6Mbps	25dBm		
			54Mbps	20dBm		
			HT20 MCS0	25dBm		
			HT20 MCS7	19dBm		
			HT40 MCS0	24dBm		
			HT40 MCS7	19dBm		
		5785MHz	6Mbps	26dBm		
			54Mbps	21dBm		
			HT20 MCS0	25dBm		
			HT20 MCS7	19dBm		
			HT40 MCS0	24dBm		
HT40 MCS7	19dBm					
Receiver Sensitivity	Data Rate	5GHz				
	6Mbps	-90dBm				
	54Mbps	-75dBm				
	HT20 MCS0	-90dBm				
	HT20 MCS7	-72dBm				
	HT40 MCS0	-88dBm				
	HT40 MCS7	-70dBm				
Max of concurrent associations	Encryption	Client Latency	TCP [each client upload and download randomly from 384Kbps to 768Kbps]		UDP [each client upload and download 2Mbps]	
			Single radio	Dual radio	Single radio	Dual radio
	WPA2-PSK	<100ms	40 clients	70clients (35 per radio)	20 clients	30clients (15 per radio)



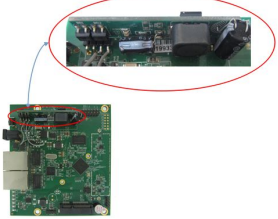
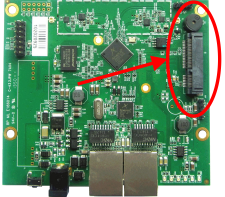

1 Serial Port is a 4-pin header (TTL) + Serial Converter is available to change the TTL signals on board to RS232 signals for debugging. Configurations are subject to change without notification

2 JTAG Port is a 14-pin header + JTAG kit is for writing your own developed loader and firmware directly

Optional configuration

<p>IEEE 802.3af module (P-3AF-M-6A01-SPL)</p>	<p>IEEE 802.3af module</p> 	<p>This is a factory option to turn YBT342LV to WPJ342HV, It is compatible with .3af/.3at PoE switches and injectors. (DC Jack:24-48V, Passive PoE:24-48v, 802.3af/at PoE)</p>
<p>3G/LTE Module</p>		<p>PCIe slot can Support mini PCIe radio or Third Party 3G/LTE Module</p>

Related Products

802.11 b/g/n 2.4GHz miniPCIe			Passive injector PoE Plus	
<p>YBTE9590NX YBTE9580NX</p> 	<p>YBTE9280NX</p> 	<p>YBTE2N9283-26</p> 	<p>POE Plus</p>  <p>- Output Voltage: 24VDC - Max Output Watts: 12W</p>	<p>PoE2405</p>  <p>- Output Voltage: 24VDC - Max Output Watts: 12W</p>

embedded board extended applications list

Model	Extended applications			
	USB signal	USB External board (USB HUB BOARD-1.00-ST)	802.3af PoE pass-thru	802.3af PoE power supply
YBT9344GLV	Support 1× USB 2.0 port	support 3 x USB 2.0 ports and 1 x miniPCIe-based USB 2.0 only interface	Optional (PSE pass-thru module)	support
YBT558GLV	Support 1× USB 2.0 port or PCIe slot Support Third Party 3G/LTE Module	support 3 x USB 2.0 ports and 1 x miniPCIe-based USB 2.0 only interface		support
YBT342LV	Support 1× USB 2.0 port or PCIe slot Support Third Party 3G/LTE Module			Optional (802.3af module)
YBT531LV	Support 1× USB 2.0 port or PCIe slot Support Third Party 3G/LTE Module			Optional (802.3af module)
YBT7161B	Support 2× USB 2.0 port		Optional (PSE pass-thru module)	support
YBT7161A	Support 2× USB 2.0 port			support

Product application:

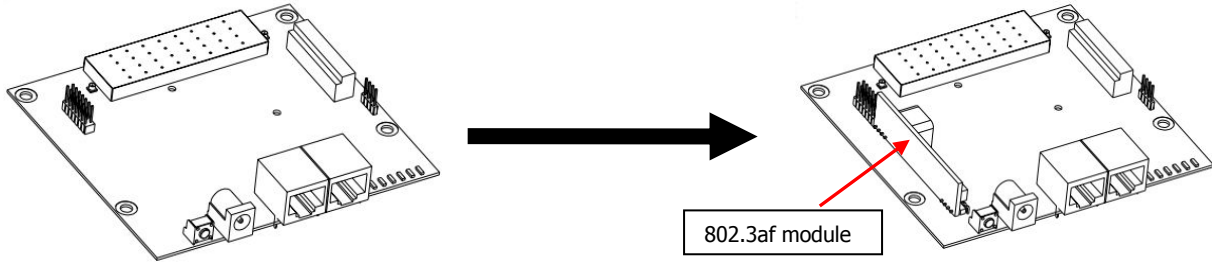

Power supply:
DC Jack Input: 12-24V, Passive PoE: 12-24V

Power supply:
DC Jack input:24-48V, Passive PoE:24-48v, IEEE 802.3af/at PoE

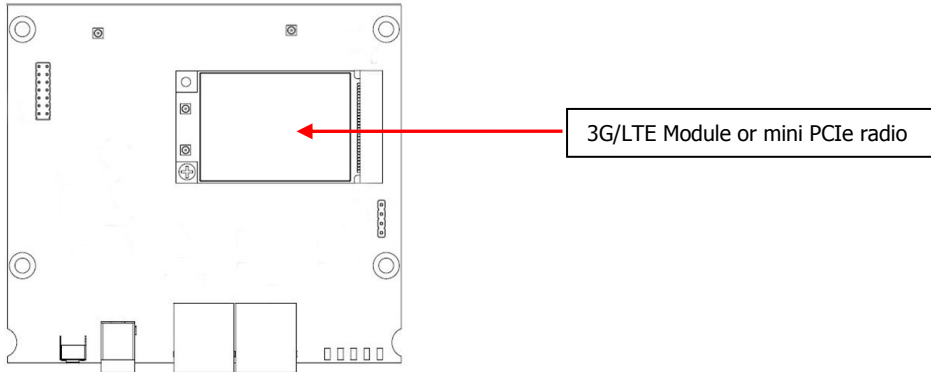

PCIe slot can Support mini PCIe radio or Third Party 3G/LTE Module

Dimension Drawing

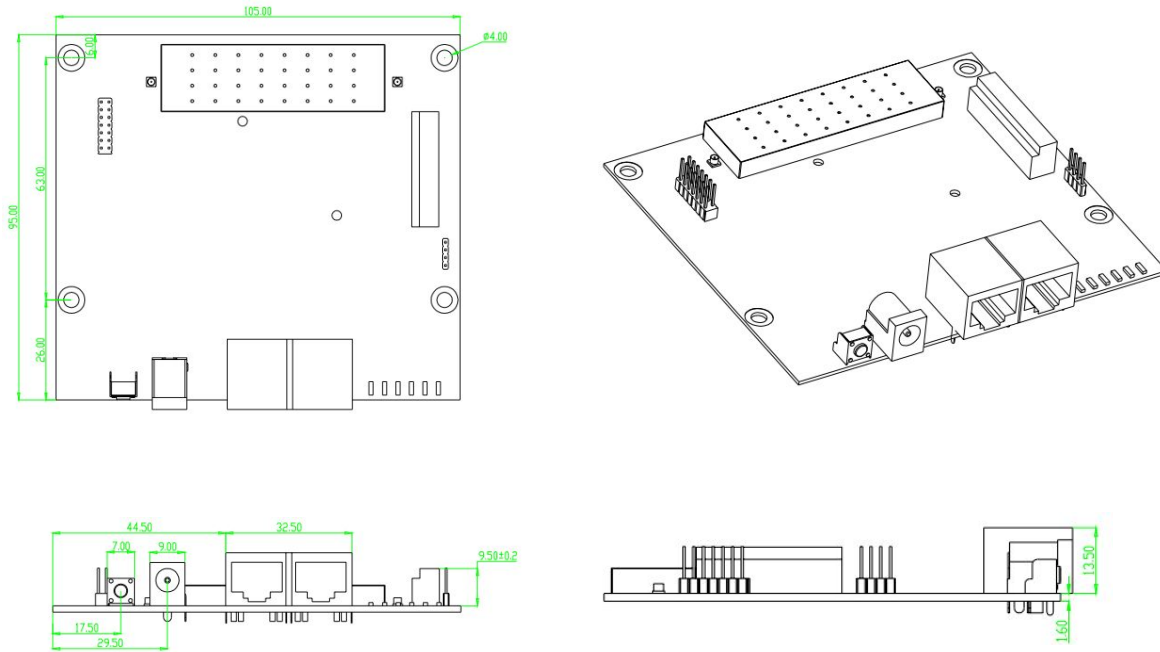

Dimension Drawing with 802.3af module

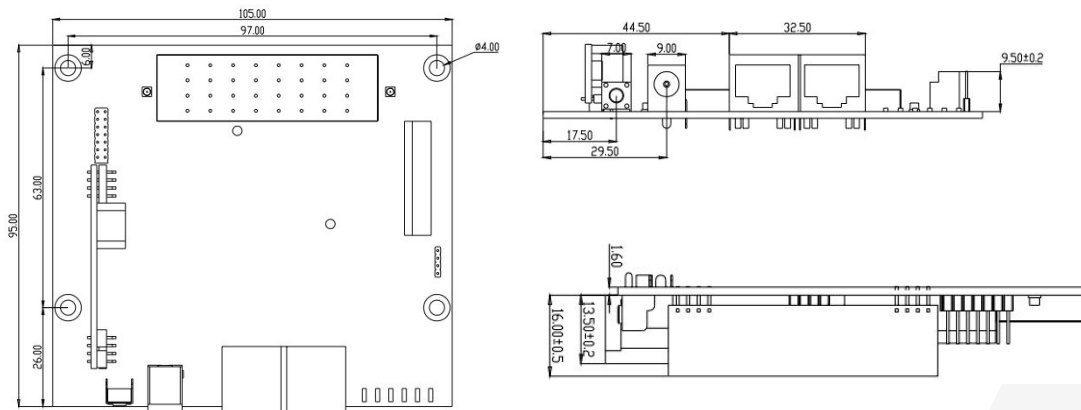

Ordering Information

Item Code	Version	Processor	L/H voltage Power Solutions	NOR Flash	Memory	Socket Height
YBT342LV 7A5PCW1664AR-B-P	CompexWRT	AR9342	Low Voltage (24V)	16M	64M	9.2mm
YBT342HV 7A5PCW1664AR-B-P	CompexWRT	AR9342	High Voltage (48V)	16M	64M	9.2mm
P-3AF-M-6A01-SPL	802.3af/at POE module					
Carton Dimension	Dimension	Weight	Dimensional Weight			
Packing BOX (50pcs)	871*320*190mm	6.135kg	11 Kg			